

JOBE BIMINI CARGO RACK

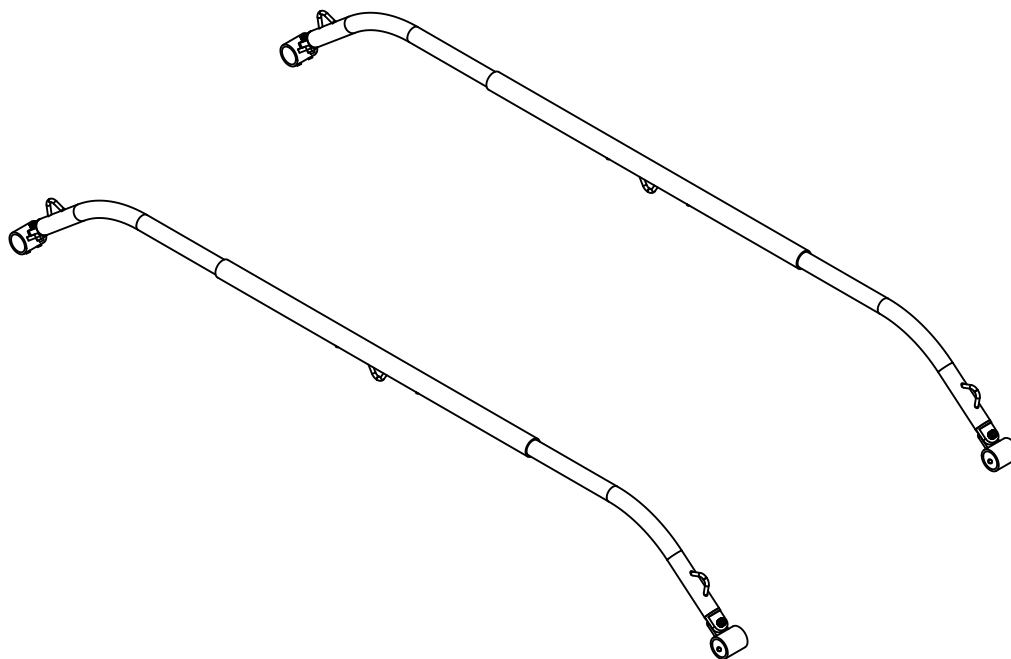

- (UK)** **THIS MANUAL MUST BE READ BEFORE USING THIS PRODUCT**
SAVE THIS OWNER'S MANUAL! KEEP FOR FUTURE REFERENCE
- (FR)** **CE MANUEL DOIT ETRE LU AVANT D'UTILISER CE PRODUIT**
GARDER LE EN REFERENCE
- (ES)** **ESTE MANUAL DEBE LEERSE ANTES DE USAR EL PRODUCTO**
GUARDAR ESTE MANUAL! TENERLO PARA FUTURAS CONSULTAS.
- (NL)** **LEES DEZE HANDLEIDING ZORGVULDIG VOORDAT U HET PRODUCT IN GEBRUIK NEEMT**
BEWAAR DEZE HANDLEIDING VOOR TOEKOMSTIG GEBRUIK
- (PT)** **LEIA ESTE MANUAL ANTES DE USAR ESTE PRODUTO**
GUARDE ESTE MANUAL DE UTILIZADOR PARA REFERÊNCIA FUTURA
- (DE)** **DIESE BEDIENUNGSANLEITUNG MUSS VOR DER VERWENDUNG DIESES PRODUKTS DURCHGELESEN WERDEN**
HEBEN SIE DIESE BEDIENUNGSANLEITUNG FÜR ZUKÜNFTIGE FRAGEN AUF

MANUFACTURED BY:
Jobe Sports International
Heerewaardensestraat 30,
6624 KK Heerewaarden
The Netherlands

tel. +31 (0) 487 573090
e-mail: info@jobesports.com
url: www.jobesports.com

JOBE 



WARNING!

⚠ WARNING NEVER EXCEED LOAD CAPACITY OF ??? KG.

⚠ WARNING ALWAYS MAKE SURE BOARD ARE SECURED WITH STRAPS ON CARGO RACK

⚠ WARNING MAX SPEED WITH CARGO RACK 50 KM/H

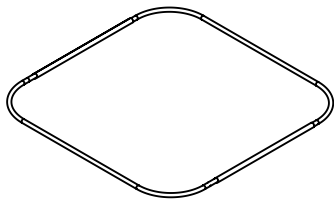
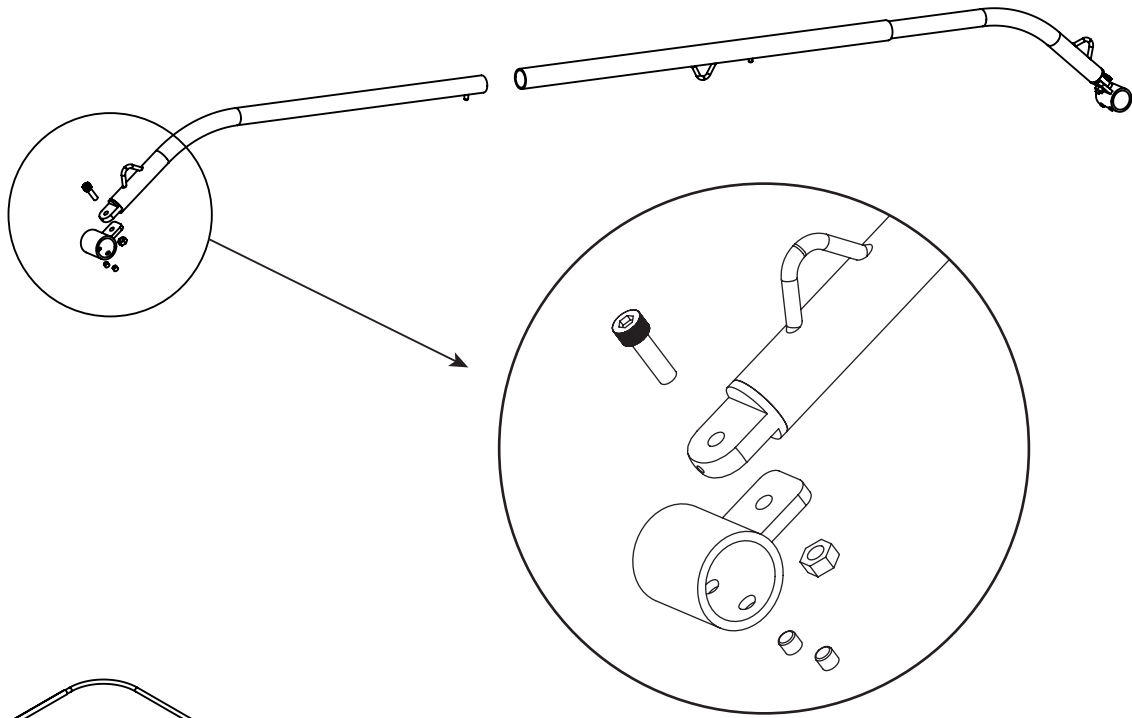

1.

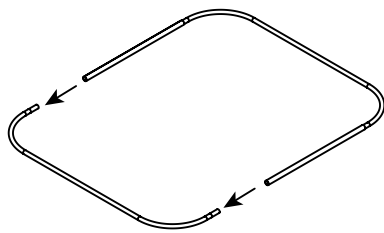

2.

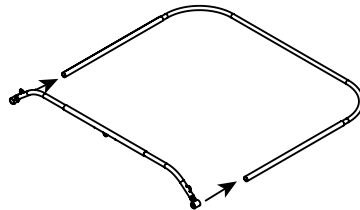

3.

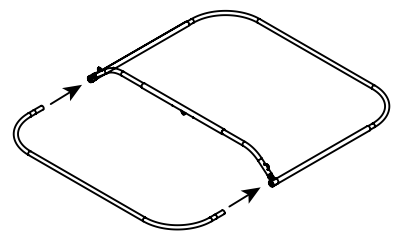

5.

HOW TO INSTALL BIMINI CARGO RACK

1. remove canopy from bimini
2. remove front part of bimini frame
3. Slide on the cargo rack
4. when reached the desired point tighten the set screws
5. Assemble bimini frame
6. repeat steps 1 - 5 for back part of the bimini